

N-Light[®] CONNECT

Installation Instructions

The N-Light[®] CONNECT Installation kit consists of the following:

INSTALLATION KIT

1. Pattress box (surface and recessed)
2. Control panel
3. Clip-on fascia
4. USB to mini USB cable
5. 2 x 25mm M3.5 electrical screws
6. 2 x 2-way DALI connector block
7. 1 x 4-way power connector block

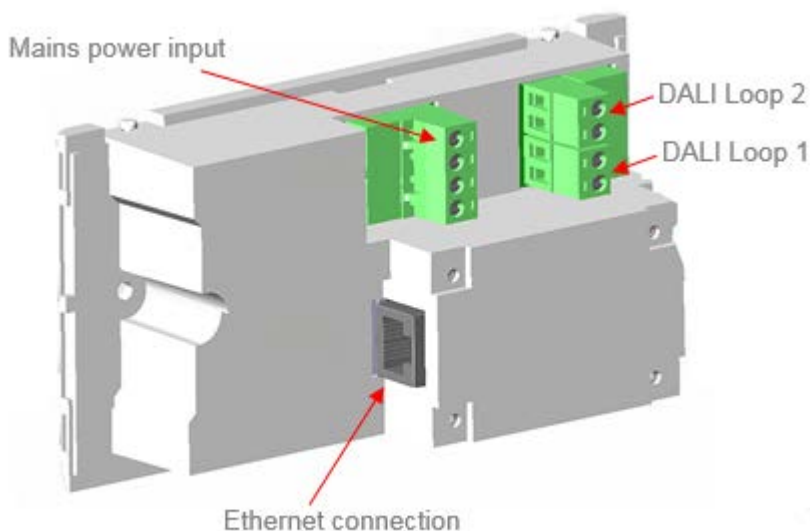

INSTALLATION DATA

RATED VOLTAGE
230V ac

FREQUENCY
50/60Hz

POWER
4.1W

TEMPERATURE RANGE
0 to +50°C

WEIGHT (including pattress)
310g

DIMENSIONS L x H x D
(including housing)
156x92x58mm

PROTECTION RATING
IP20 - Suitable for indoor use only

CONNECTION DATA

DALI 1 & 2
2-core mains rated 0.5 to 1.5mm²

POWER
3-core T&E 2.5mm²

NETWORK
Cat5e Ethernet cable RJ45 to RJ45

USB
Front facing mini-USB

CONTROL CONNECTIONS

DALI
2 x subnet to DALI slave devices

POWER CONNECTION

MAINS SUPPLY
Mains power supply protected at external supply

NETWORK CONNECTION

ETHERNET BACKBONE
RJ45 port to PC or network switch

UK MANUFACTURED 

email. sales@mackwell.com

www.mackwell.com

tel. +44 (0) 1922 458 255

Vigo Place, Aldridge, West Midlands, WS9 8UG, England

N-Light[®] CONNECT

Installation Instructions

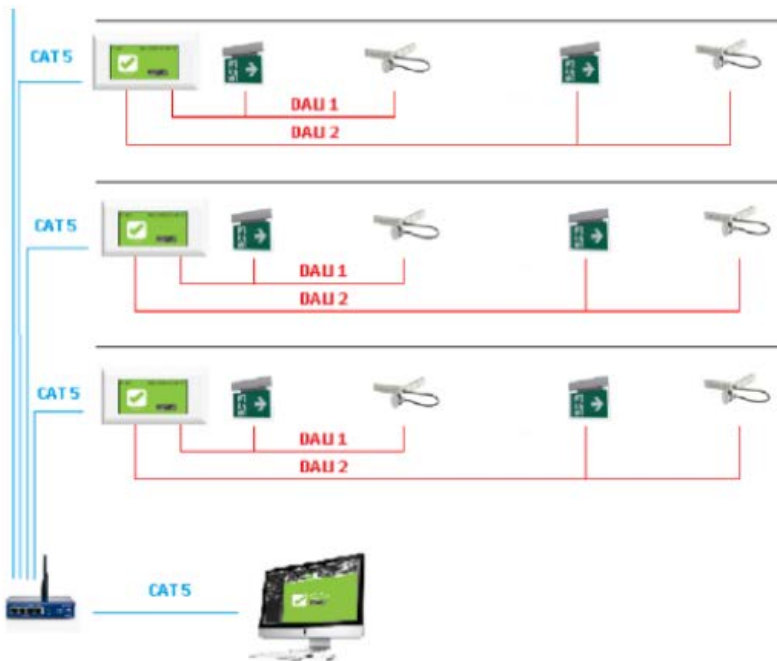

INSTALLATION REQUIREMENTS

1. The panel can be recessed or surface-mounted
2. Dimensions for cavity wall cut-out approx. 133mm x 75mm. A depth of at least 47mm is required for a neat fit
3. Typical DALI cable is 2-core 1.5mm² mains rated – thinner diameter cable may reduce the maximum wire length
4. DALI wiring topology is line, star or tree (or a combination of these)
5. Maximum distance between panel and furthest device is 300m if 1.5mm² cable is used. Cable temperature will have an effect on maximum cable runs
6. DALI subnet maximum 64 slave devices
7. Ethernet connection for networking panels. RJ45 port can be used for direct access or networking panels to a switch
8. Typical Ethernet cable is Cat5e
9. Commissioned by an accredited partner using N-light[®] software

Mackwell maintains a policy of continuous development and reserves the right to change the details shown on this data sheet without prior notice.

The contents are intended for guidance only.

Company Reg No: 1414873. VAT Reg No GB330230618



UK MANUFACTURED 

email. sales@mackwell.com

www.mackwell.com

tel. +44 (0) 1922 458 255

Vigo Place, Aldridge, West Midlands, WS9 8UG, England

N-Light[®] CONNECT

Installation Instructions

INSTALLATION PROCESS

STAGE 1

Prepare recess or conduit for fitment of pattress. Pass the power, network and DALI cables through the pattress and terminate in the 2 x 2-way DALI connector block and the 1 x 4-way power connector block.

STAGE 2

Plug connector blocks into the sockets on the rear of the panel. Plug the network cable into the RJ45 socket. Carefully align the panel with the fixing holes and push into place in the pattress box so that it fits firmly in place.

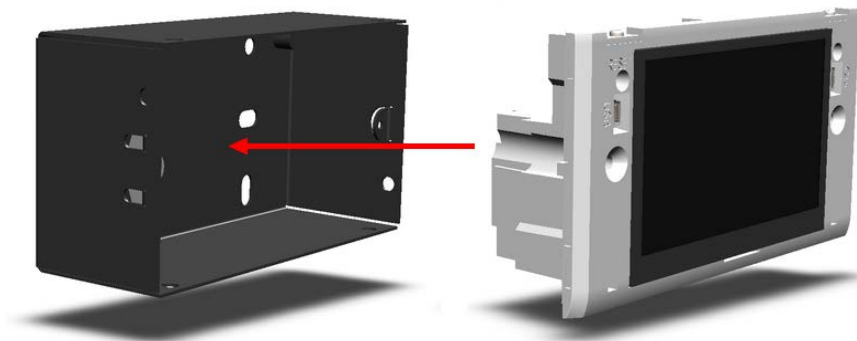

Mackwell maintains a policy of continuous development and reserves the right to change the details shown on this data sheet without prior notice.

The contents are intended for guidance only.

Company Reg No: 1414873. VAT Reg No GB330230618



UK MANUFACTURED 

email. sales@mackwell.com

www.mackwell.com

tel. +44 (0) 1922 458 255

Vigo Place, Aldridge, West Midlands, WS9 8UG, England

N-Light[®] CONNECT

Installation Instructions

STAGE 3

Use the M3.5 screws provided to secure the panel to the pattress box.

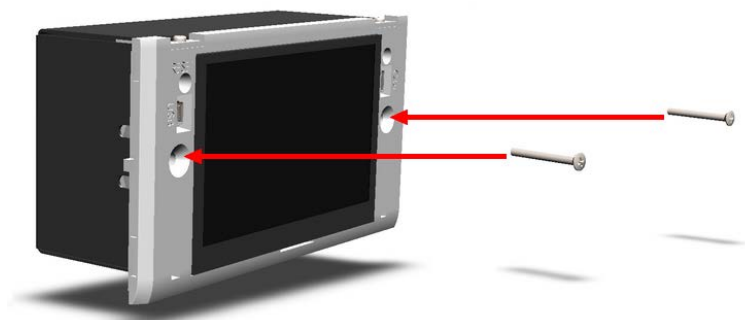

STAGE 4

Clip on the decorative fascia, ensuring that the hole in the fascia is in the top right hand corner.

System installation is complete and ready for commissioning. Please contact Mackwell Support Services.

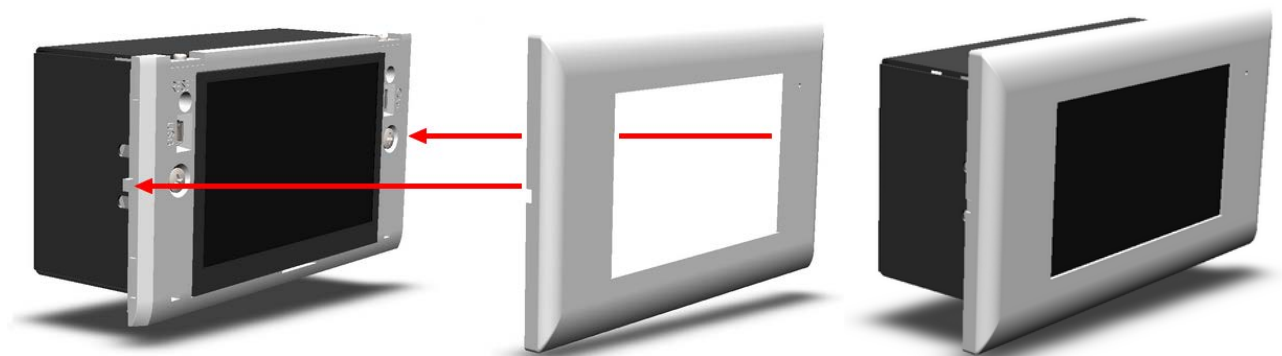

To prevent unnecessary discharging of emergency batteries, it is recommended that mains power is disconnected after installation and not re-applied until the system is to be commissioned.

DALI COMPATIBILITY NOTE

All Mackwell DALI modules are designed to comply with the DALI Standard EN 62386, for emergency lighting components. Customers who purchase product that incorporates the DALI protocol must accept full system responsibility for the integration of the Mackwell modules into the DALI system and have the experience and resource to accept this responsibility. Please note that product warranty does not extend to cover the system integration process. Please contact Mackwell Support Services on nlight-support@mackwell.com for further information.

Mackwell maintains a policy of continuous development and reserves the right to change the details shown on this data sheet without prior notice.

The contents are intended for guidance only.

Company Reg No: 1414873. VAT Reg No GB330230618



UK MANUFACTURED 

[email. sales@mackwell.com](mailto:sales@mackwell.com)

www.mackwell.com

tel. +44 (0) 1922 458 255

Vigo Place, Aldridge, West Midlands, WS9 8UG, England